

The *YATE* (Plots 42, 43, 53, 54, 55, 56, 57 & 58)

2 Bedroom Semi-Detached Home



This CGI is an indicative representation of the external finish of this house type on one of the properties on this development. Our sales representative will be happy to discuss the external finish on any specific plot with you.

The *YATE* (Plots 42, 43, 53, 54, 55, 56, 57 & 58)

2 Bedroom Semi-Detached Home

ROOM	IMPERIAL / "	METRIC / mm
Living / Diner	13' 0" x 13' 9"	3970 x 4190mm
Kitchen	6' 2" x 11' 1"	1868 x 3368mm

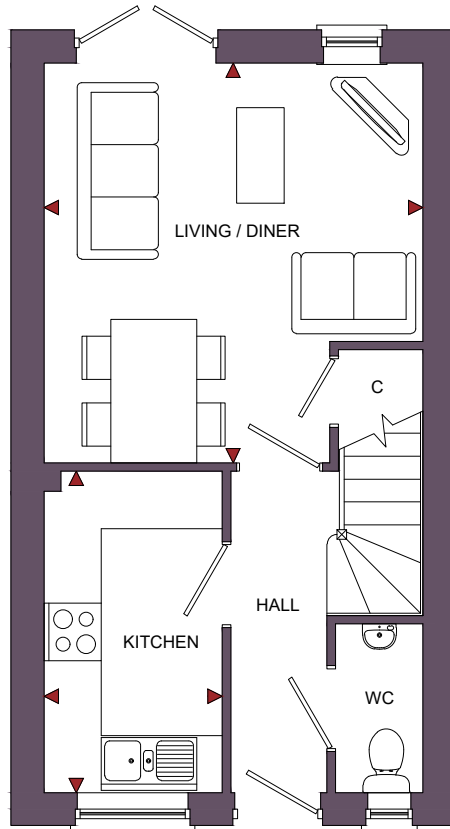

GROUND FLOOR

TOTAL FLOOR AREA
653ft² / 60.7m²

The *Spires*

Moreton-on-Lugg, Herefordshire, HR4 8DE

ROOM	IMPERIAL / "	METRIC / mm
Bedroom 1	13' 0" x 9' 7"	3970 x 2917mm
Bedroom 2	13' 0" x 8' 6"	3970 x 2578mm
Bathroom	6' 5" x 6' 6"	1943 x 1975mm

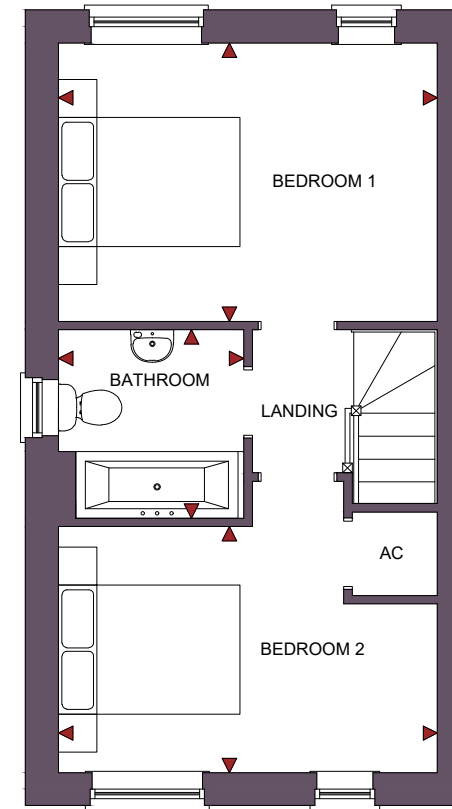

FIRST FLOOR

www.bellhomes.com

bellhomes

the name that stands for quality homes

We strive to make each home and development as varied and interesting as possible. Therefore the above is for illustration purposes only and individual properties may vary. Please ask for details of specific properties. Every care has been taken with the preparation of this information, which has been produced for your guidance only and does not form part of a contract. The Plans are NOT TO SCALE. Please do not use this information for purchase of furnishings and furniture.