

# The *BEWDLEY* (Plots 1 & 2)

3 Bedroom Semi-Detached Home





# The **BEWDLEY** (Plots 1 & 2)

3 Bedroom Semi-Detached Home

ROOM	IMPERIAL / "	METRIC / mm
Living Room	17' 8" x 10' 10"	5385 x 3287mm
Kitchen / Diner	10' 7" x 11' 9"	3210 x 3587mm

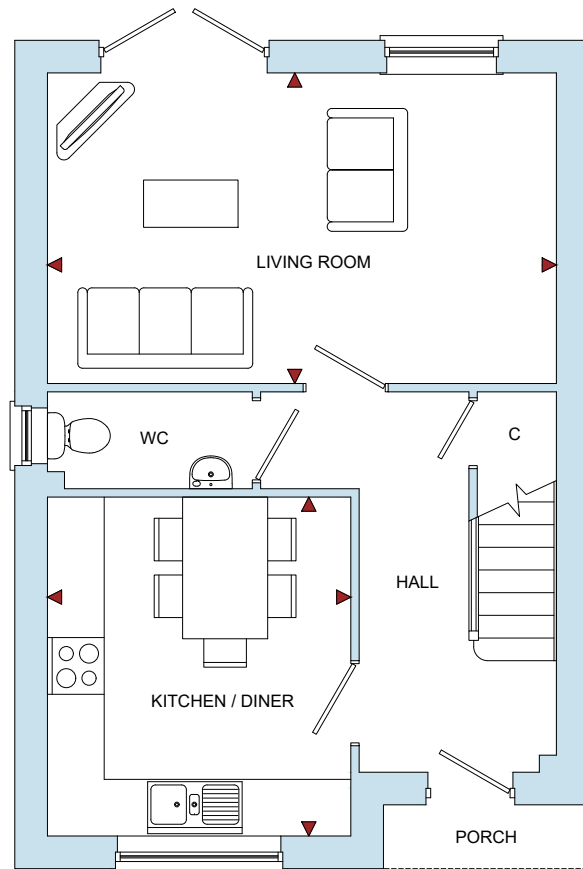

GROUND FLOOR

**TOTAL FLOOR AREA**  
905ft<sup>2</sup> / 84m<sup>2</sup>

# The **Vines**

Redmarley D'Abitot, Gloucestershire, GL19 3HS

ROOM	IMPERIAL / "	METRIC / mm
Bedroom 1	11' 1" x 12' 0"	3367 x 3662mm
Bedroom 2	10' 5" x 10' 10"	3168 x 3287mm
Bedroom 3	7' 0" x 10' 10"	2129 x 3287mm
Bathroom	6' 2" x 6' 6"	1880 x 1975mm
En-Suite	6' 4" x 7' 2"	1930 x 2174mm

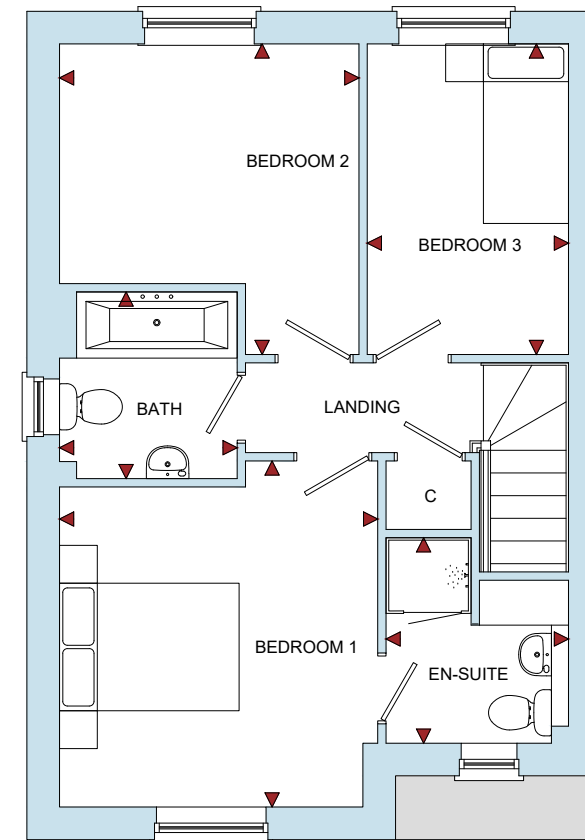

FIRST FLOOR

[www.bellhomes.com](http://www.bellhomes.com)

**bellhomes**

the name that stands for quality homes

We strive to make each home and development as varied and interesting as possible. Therefore the above is for illustration purposes only and individual properties may vary. Please ask for details of specific properties. Every care has been taken with the preparation of this information, which has been produced for your guidance only and does not form part of a contract. The Plans are NOT TO SCALE. Please do not use this information for purchase of furnishings and furniture.

**The Vines, Redmarley D'Abitot, Gloucestershire, GL19 3HS**

**The Bewdley Semi Detached**

**Key Features/Included Specification**

- Help to Buy Available
- Choice of Kitchen and Worktops
- Choice of Wall and Floor Tiles to Kitchen and Bathrooms
- Choice of Carpets
- Bosch Single Oven, Hob & Chimney Hood
- Downlighters to Kitchen and Bathrooms
- Large Lounge with French Doors to Rear Garden
- Kitchen with Dining Area
- En-Suite to Main Bedroom
- Further Double Bedroom
- Downstairs W/C
- Family Bathroom
- Storage Cupboard to Hallway and Landing
- 2 Off-Road Parking Space
- Electric Car Charging Point
- Grey UPVC Windows & Fascia
- Optional Rear Access to Large Communal Garden and Wildflower Area
- Great Location in Popular Village

