

The *YATE* (Plots 27 - 29)

2 Bedroom Semi-Detached / Terraced Home



The *YATE* (Plots 5, 6, 27, 28 & 29)

2 Bedroom Semi-Detached / Terraced Home

ROOM	IMPERIAL / "	METRIC / mm
Living / Diner	13' 0" x 13' 9"	3970 x 4190mm
Kitchen	6' 2" x 11' 1"	1868 x 3368mm

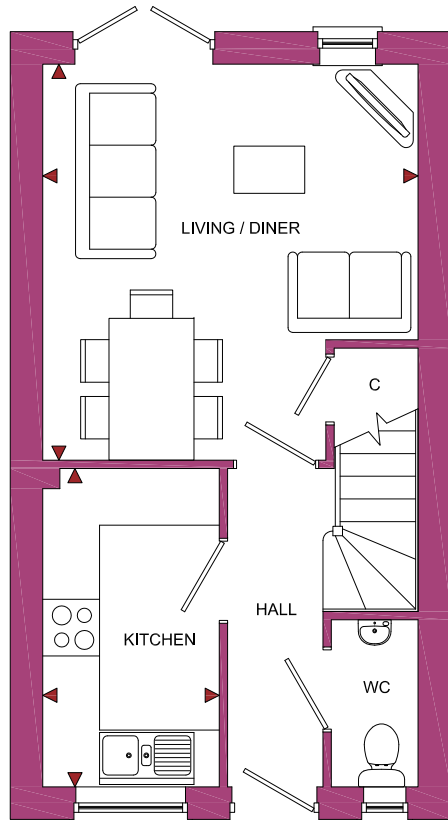

GROUND FLOOR

★ Bathroom window only in Plots 5, 6, 27 & 29.
No Bathroom window in Plot 28.

www.bellhomes.com

TOTAL FLOOR AREA
653ft² / 60.7m²

Vine Tree Gardens

Withington, Herefordshire, HR1 3QW

ROOM	IMPERIAL / "	METRIC / mm
Bedroom 1	13' 0" x 9' 7"	3970 x 2917mm
Bedroom 2	13' 0" x 8' 6"	3970 x 2578mm
Bathroom	6' 5" x 6' 6"	1943 x 1975mm

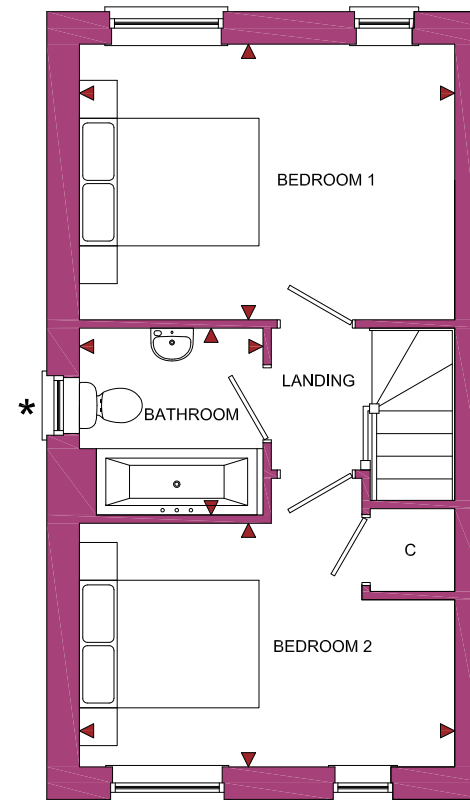

FIRST FLOOR



bellhomes

the name that stands for quality homes

We strive to make each home and development as varied and interesting as possible. Therefore the above is for illustration purposes only and individual properties may vary. Please ask for details of specific properties. Every care has been taken with the preparation of this information, which has been produced for your guidance only and does not form part of a contract. The Plans are NOT TO SCALE. Please do not use this information for purchase of furnishings and furniture.

Vine Tree Gardens, Withington, Herefordshire, HR1 3QW

The Yate

Key Features/Included Specification

- Low Cost 2 Bedroom Home
- Choice of Kitchen and Worktops
- Oven, Hob & Chimney Hood included
- Lounge/Dining Room with French Doors to Rear Garden
- Separate Fitted Kitchen
- 2 Double Bedrooms
- Family Bathroom with Bath and Shower Over Bath
- Downstairs W/C
- Private Garden
- 2 Off Road Parking Spaces

