

The *BEWDLEY* (Plots 30 & 31)

3 Bedroom Detached Home



The *BEWDLEY* (Plots 30 & 31)

3 Bedroom Detached Home

Vine Tree Gardens

Withington, Herefordshire, HR1 3QW

ROOM	IMPERIAL / "	METRIC / mm
Living Room	17' 8" x 10' 10"	5385 x 3287mm
Kitchen	10' 7" x 11' 9"	3210 x 3587mm

ROOM	IMPERIAL / "	METRIC / mm
Bedroom 1	11' 1" x 12' 0"	3367 x 3662mm
Bedroom 2	10' 5" x 10' 10"	3168 x 3287mm
Bedroom 3	7' 0" x 10' 10"	2129 x 3287mm
Bathroom	6' 2" x 6' 6"	1880 x 1975mm
En-Suite	6' 4" x 7' 2"	1930 x 2174mm

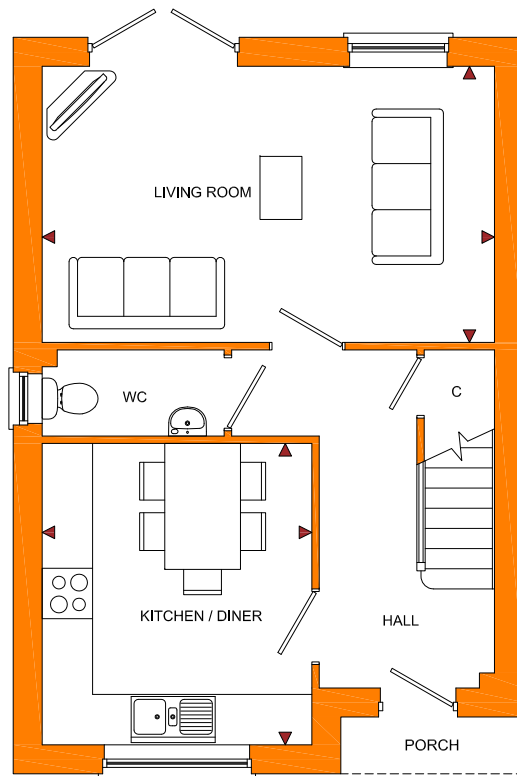

GROUND FLOOR

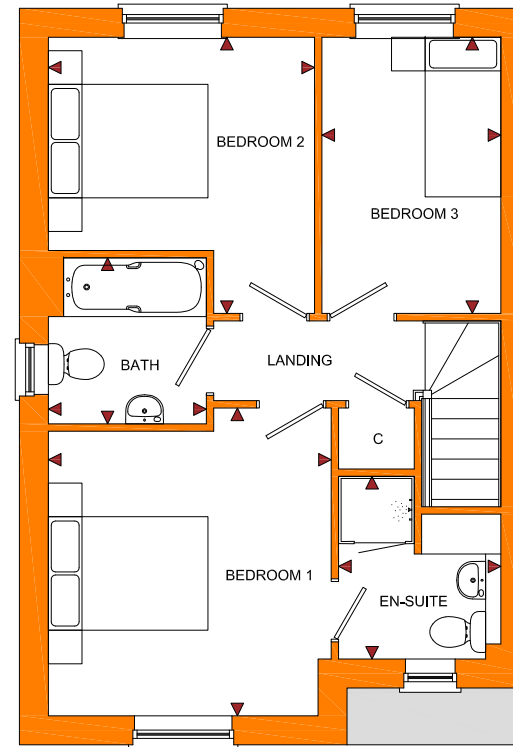

FIRST FLOOR

TOTAL FLOOR AREA
905ft² / 84m²

www.bellhomes.com

bellhomes
the name that stands for quality homes

We strive to make each home and development as varied and interesting as possible. Therefore the above is for illustration purposes only and individual properties may vary. Please ask for details of specific properties. Every care has been taken with the preparation of this information, which has been produced for your guidance only and does not form part of a contract. The Plans are NOT TO SCALE. Please do not use this information for purchase of furnishings and furniture.

Vine Tree Gardens, Withington, Herefordshire, HR1 3QW

The Bewdley

Key Features/Included Specification

- Help to Buy Available
- Detached Property
- Choice of Kitchen and Worktops
- Choice of Wall and Floor Tiles to Kitchen and Bathrooms
- Choice of Carpets
- Oven, Hob & Chimney Hood
- Downlighters to Kitchen and Bathrooms
- Large Lounge with French Doors to Rear Garden
- Kitchen with Dining Area
- En-Suite to Main Bedroom
- Further Double Bedroom
- Downstairs W/C
- Family Bathroom
- Storage Cupboard to Hallway and Landing
- Single Detached Garage with 2 Additional Parking Spaces

