

The *REDMARLEY* (Plot 19)

3 Bedroom Terraced Home



The **REDMARLEY** (Plot 19)

3 Bedroom Terraced Home

ROOM	IMPERIAL / "	METRIC / mm
Living/ Diner	16' 8" x 15' 0"	4560 x 5072mm
Kitchen	7' 8" x 10' 10"	2330 x 3300mm

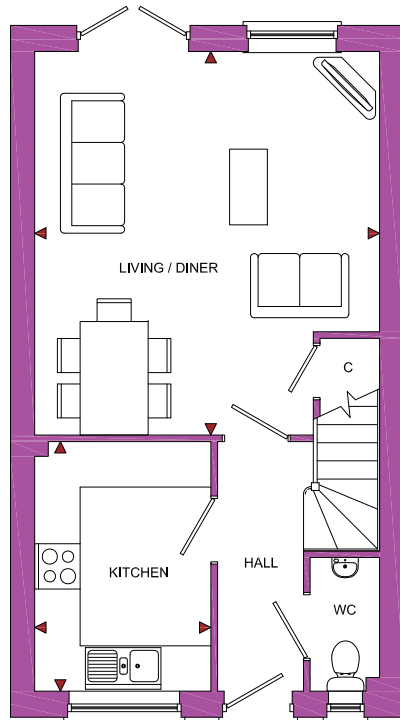

GROUND FLOOR

TOTAL FLOOR AREA
830ft² / 77.2m²

Squires Meadow

Lea, Herefordshire, HR9 7JZ

ROOM	IMPERIAL / "	METRIC / mm
Bedroom 1	11' 8" x 9' 10"	3555 x 3000mm
Bedroom 2	8' 3" x 11' 10"	2517 x 3607mm
Bedroom 3	6' 5" x 9' 5"	1955 x 2869mm
Bathroom	8' 3" x 5' 6"	2517 x 1678mm
En-Suite	4' 8" x 5' 10"	1417 x 1768mm

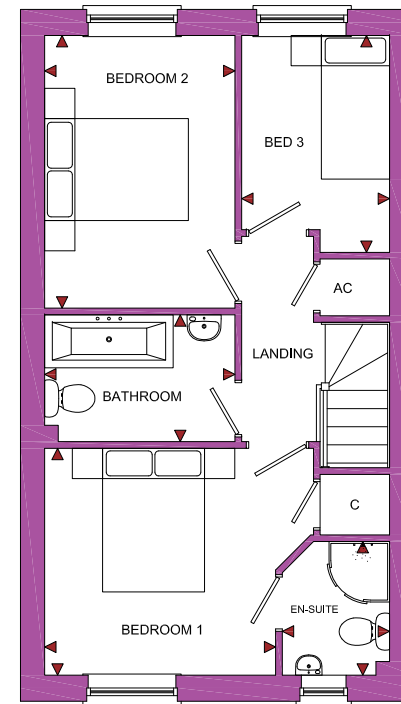

FIRST FLOOR

www.bellhomes.com

We strive to make each home and development as varied and interesting as possible. Therefore the above is for illustration purposes only and individual properties may vary. Please ask for details of specific properties. Every care has been taken with the preparation of this information, which has been produced for your guidance only and does not form part of a contract. The Plans are NOT TO SCALE. Please do not use this information for purchase of furnishings and furniture.

bellhomes

the name that stands for quality homes

Squires Meadow, Lea, Ross-On-Wye, Herefordshire, HR9 7JZ

The Redmarley

Key Features/Included Specification

- Low Cost 3 Bedroom Home
- Choice of Kitchen and Worktops
- Choice of Wall and Floor Tiles to Kitchen and Bathrooms
- Choice of Carpets
- Beko Oven, Hob & Chimney Hood
- En-suite to Main Bedroom
- Open Plan Lounge/Dining Room with French Doors to Rear Garden
- Separate Fitted Kitchen
- Further Double Bedroom
- Family Bathroom with Bath and Shower
- Downstairs W/C
- Two Off Road Parking Spaces
- Great Location in Popular Village

